

MahaRERA Registration No. P51700023125

# EMPERIA ICON

Available Office Area - 520 , 700 Sqft |  
720 , 954 Sqft | 1006 - Sqft

₹ 39 LAKHS \*  
ONWARDS

+91 - 8779 491 119

+91 - 9167 444 788

+91 - 9920 562 625

+91 - 9920 359 301

Address: Emperia Icon, Nerul, Navi Mumbai - 400706.

MARKETED BY

**RAYEEN**  
**ESTATES**

MahaRERA No : A51700020875

+91-8779 491 119

+91-9167 444 788

+91-9920 359 301

**G+36 FLOORS**  
**COMMERCIAL WORKSPACE**  
**5 FLOORS OF PARKING**

+91-8779 491 119  
+91-9167 444 788  
+91-9920 359 301

5 Mins Walking distance from Jui-Nagar Railway Station

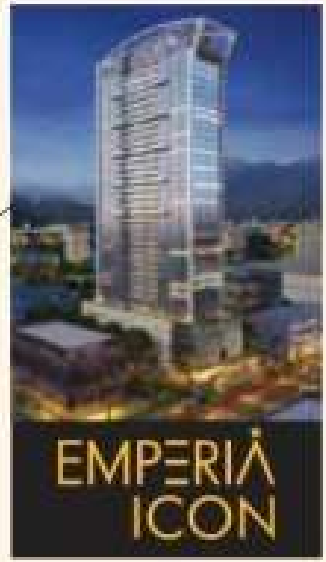
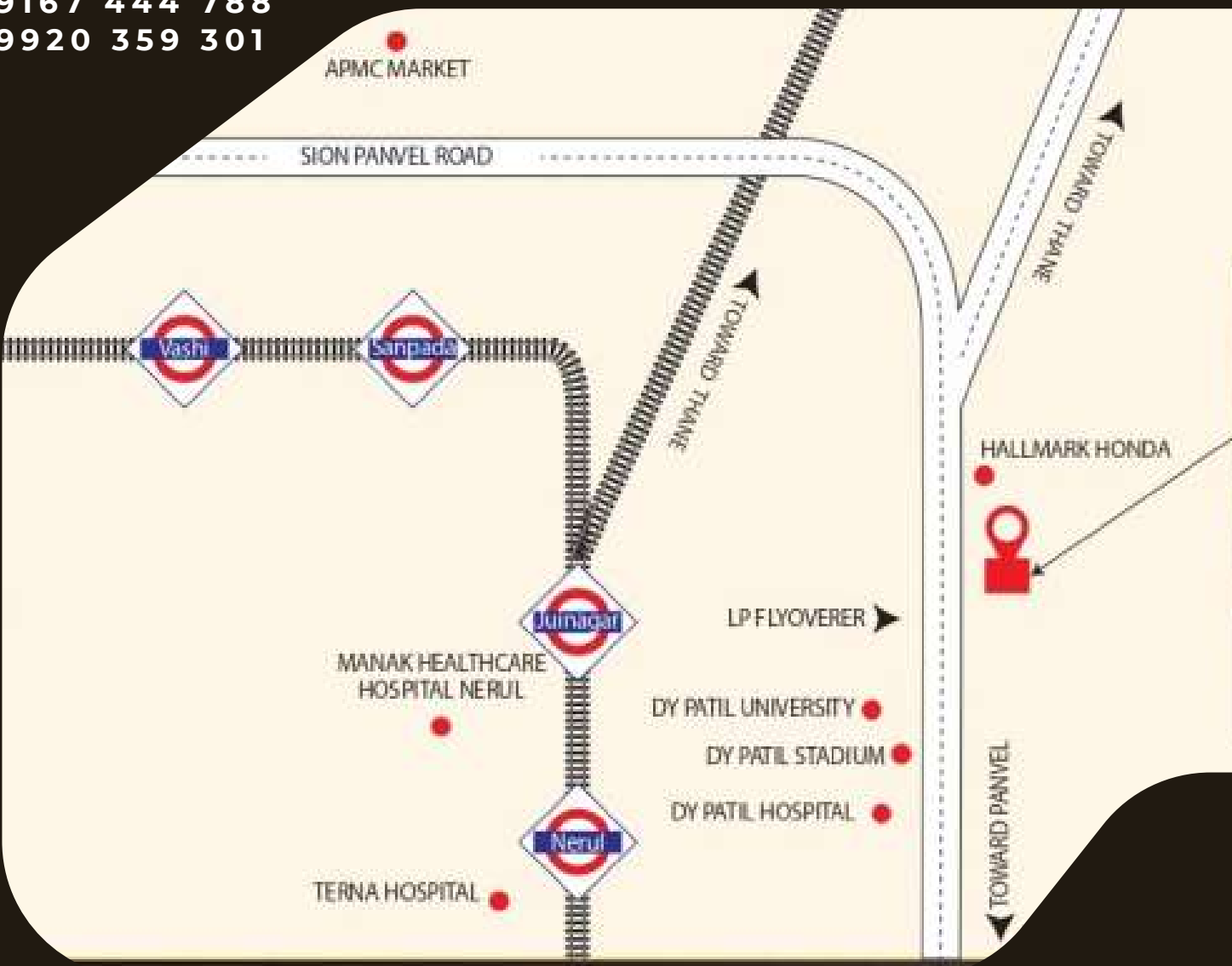

# EMPERIA ICON

Exclusive  
Offices Space  
Starting From

₹ 39 Lakhs\* Onwards

MahaRERA Registration No. P51700023125

MARKETED BY

MahaRERA No : A51700020875

Call Now  
8779 491 119





MARKETED BY

**RAYEEN**  
**ESTATES**

MahaRERA No : A51700020875

+91-8779 491 119  
+91-9167 444 788  
+91-9920 359 301

# IT OFFICE FOR SALE

## G+5 Storey Car Parking Space

- Electric Car Charging Station on All Parking Floors
- G+36 Storey IT/ITES Commercial Office Tower
- Glass Façade Elevation with
- 11 Feet Height on each floor
- 4 High Speed Elevator & 2 Service Lifts

MahaRERA Registration No. P51700023125

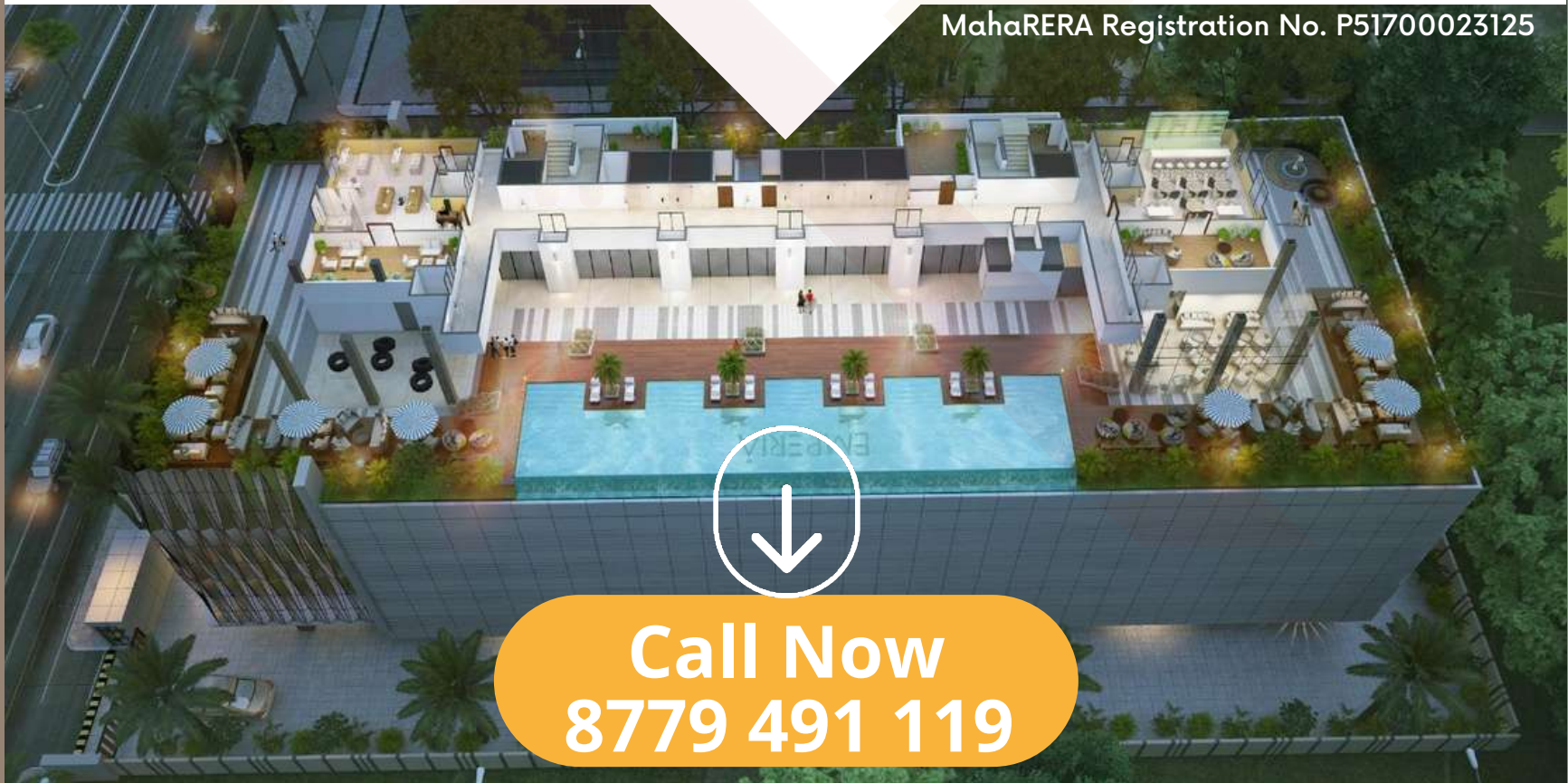

**Call Now**  
**8779 491 119**

# EMPERIA ICON

Luxurious Commercial Workspace

**Book Now**



MahaRERA Registration No. P51700023125



Start From  
**₹ 39 Lakhs\*** Onwards



**EMPERIA ICON - NERUL**





## OFFICE AREA & PRICING

- 520 - 700 Sqft | ₹ 39 Lakhs to 52.50 Lakhs\*
- 720 - 954 Sqft | ₹ 55 Lakhs to 71.55 Lakhs\*
- 1006 Sqft | ₹ 74.50 Lakhs\*





# The Iconic Top of the world life



Emperia ICON is truly magnificent and modern-day Business workspace. An enticing splendid facade along with state of the art amenities it's altogether great place to own. It consists of **G+36 Storey, 5 floors of parking** and stylish work space right from the boutique offices to large workspace.

## COME OWN A SPACE, IT'S YOUR WORLD

- ★ G+36 Storey Commercial IT/ITES Business Park
- ★ Glass Facade Elevation
- ★ 5 Level Covered Parking Area
- ★ Electric Charging Station on all Parking Floors
- ★ 5 Miconic High Speed Branded Elevators plus 2 Service lifts
- ★ Bare Shell Offices







# EMPERIA ICON

MARKETED BY  
**RAYEEN**  
**ESTATES**

MahaRERA No : A51700020875

**+91-8779 491 119**  
**+91-9167 444 788**  
**+91-9920 359 301**

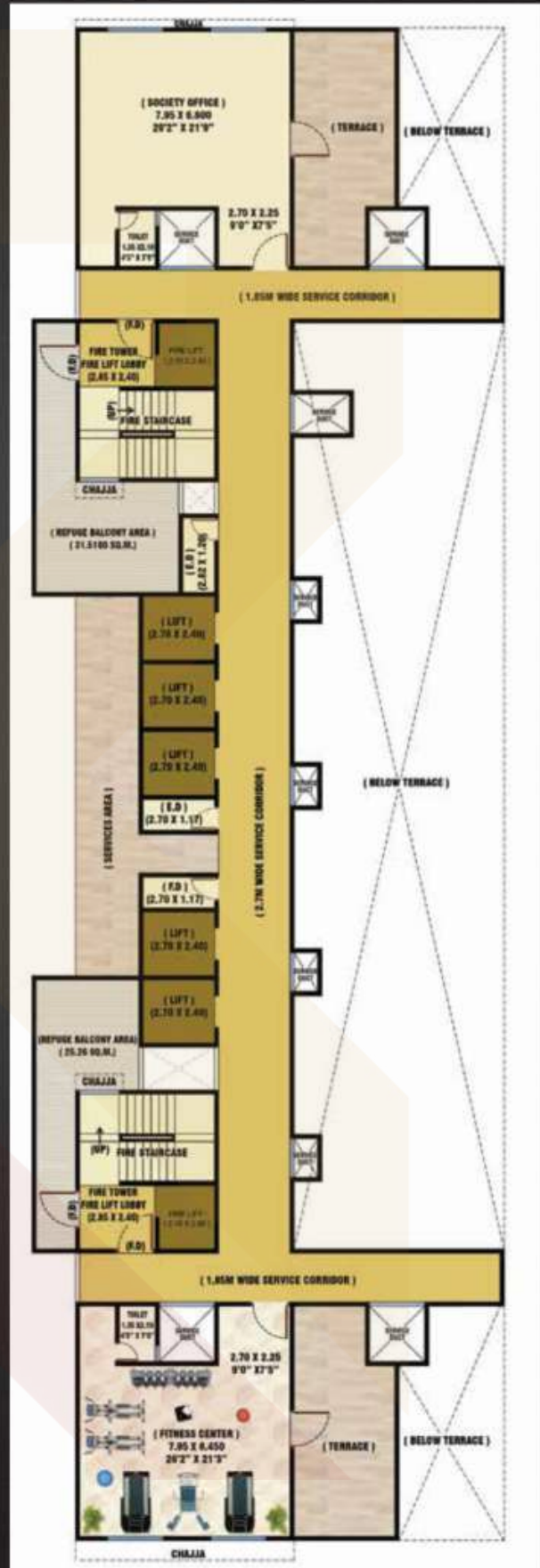





( 1.85M WIDE SERVICE CORRIDOR )

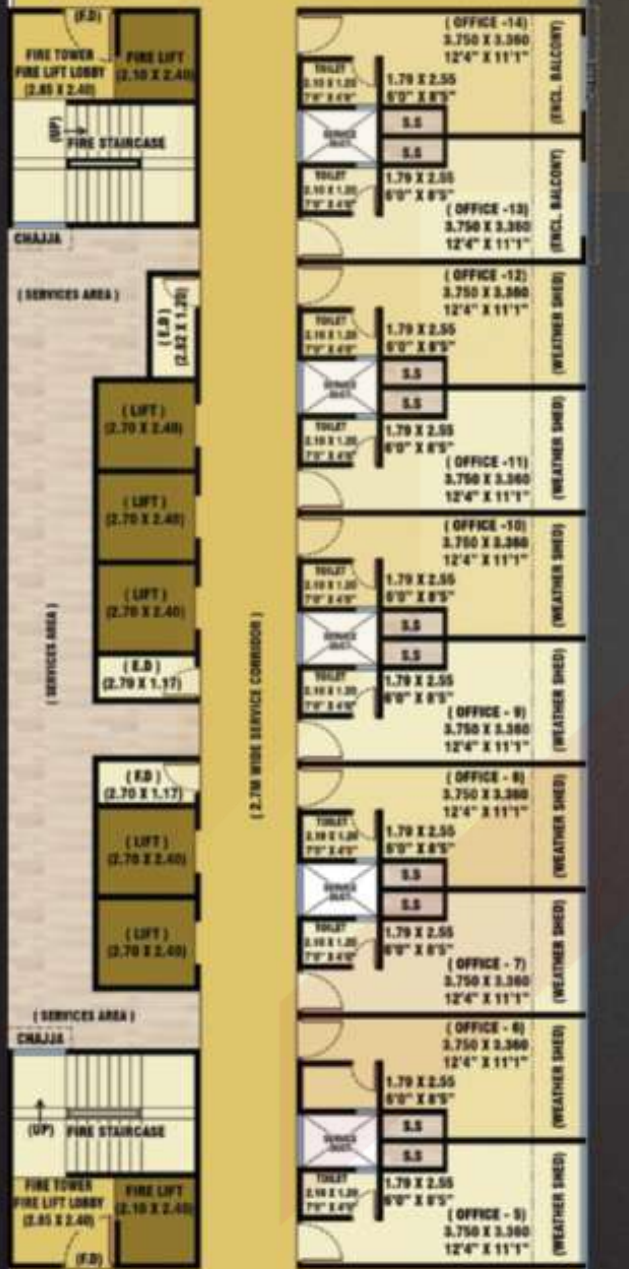

( 1.85M WIDE SERVICE CORRIDOR )

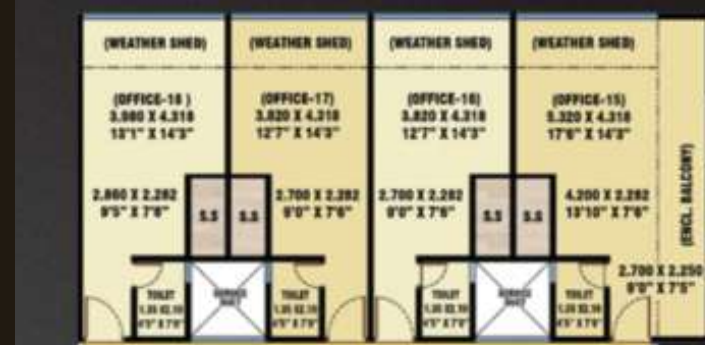
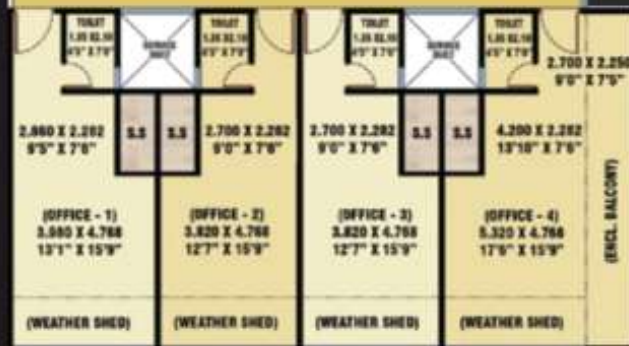

( 1.85M WIDE SERVICE CORRIDOR )

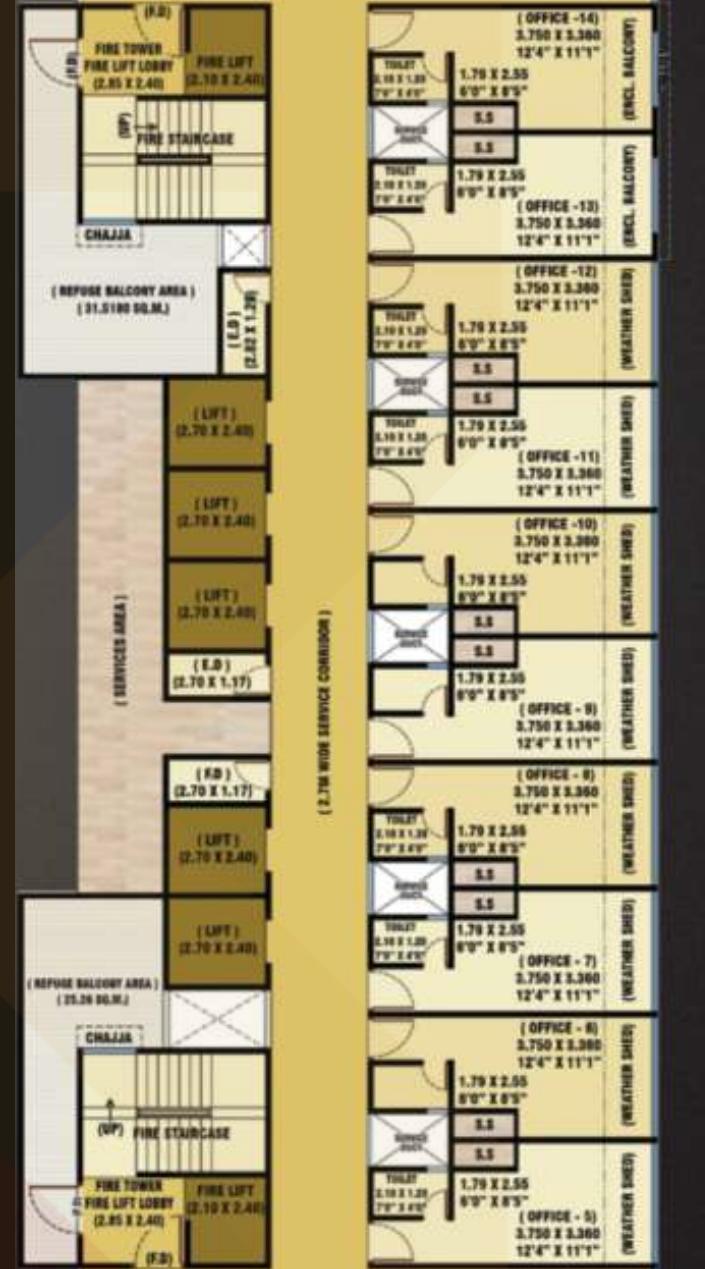

( 1.85M WIDE SERVICE CORRIDOR )

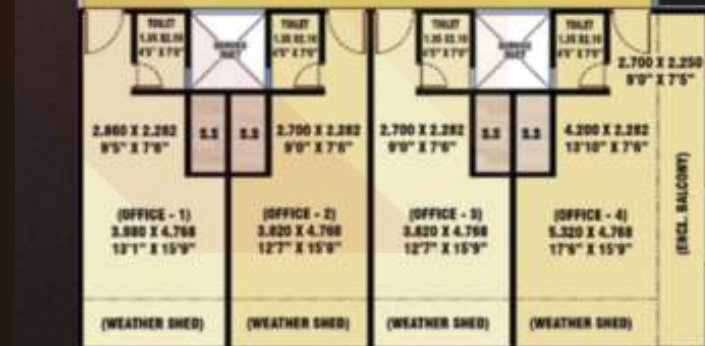

# EMPERIA ICON

MARKETED BY



MaharERA No : A51700020875

+91-8779 491 119

+91-9167 444 788

+91-9920 359 301



# 36th Floor Plan

# Isometric Plan 500 Sq Ft. Floor Plan



# EMPERIA ICON

MARKETED BY



MahaRERA No : A51700020875

- +91-8779 491 119
- +91-9167 444 788
- +91-9920 359 301

Full Floor Plan

EMPERIA  
ICON



MARKETED BY

**RAYEEN**  
**ESTATES**

MahaRERA No : A51700020875

+91-8779 491 119

+91-9167 444 788

+91-9920 359 301



THANK YOU

MahaRERA Registration No. P51700023125

# EMPERIA ICON

Available Office Area - 520 , 700 Sqft |  
720 , 954 Sqft | 1006 - Sqft

MARKETED BY

**RAYEEN**  
**ESTATES**

MahaRERA No : A51700020875

+91-8779 491 119

+91-9167 444 788

+91-9920 359 301

₹ 39 LAKHS \*  
ONWARDS

+91 - 8779 491 119

+91 - 9167 444 788

+91 - 9920 562 625

+91 - 9920 359 301

Address: Emperia Icon, Nerul, Navi Mumbai - 400706.

**G+36 FLOORS**  
**COMMERCIAL WORKSPACE**  
**5 FLOORS OF PARKING**